

# ProFAC

## Face & RFID Access Control Terminal



**ProFAC** is an access control terminal with RFID and face detection capability. With ZKTeco's latest ZKFACE version 7.0 high-speed face recognition algorithm and ZMM220 hardware platform (1.2GHZ clock rate), it has extremely high verification speed and low error rate. The ProFAC can hold up to 2000(1:N) facial templates, 4000 (1:1) facial templates, and 10,000 RFID cards. It is compatible with third party controllers and devices like electric door locks, alarms, door bells, and door sensors.

# Features



Advanced Face Recognition Technology



Simple Management & Scalability



Multiple Verification Modes: Face/ Card / Password



Built In Camera  
\* Event Snapshot  
\* User Photo



TFT-LCD Color Touch Screen



## Specifications (GL Exclusive Feature)

### Capacity

Faces 2,000 (1:N) / 4,000 (1:1)  
Cards 10,000  
Transactions 100,000  
User Photos 4,000  
Event Photos 2,000

### Communication

GL TCP / IP  
USB Host  
Wiegand Input / Output  
Security Relay Box

### Access Control Interface

Lock Relay Output  
Alarm Output / Auxiliary Input  
Exit Button / Door Sensor  
Doorbell Output

### Hardware

GL 1.2GHz High Speed CPU  
GL Memory 128MB RAM / 256MB Flash  
GL 2.8 Inches TFT-LCD Touch Screen  
125KHz EM Reader / Mifare (Optional)  
Hi-Fi Voice & Indicator  
Tamper Switch Alarm  
GL Dual IR Camera

### Standard Functions

Access Levels / Groups / Holidays  
DST / Bell Schedule  
Duress Mode (Password) Anti-Passback  
Record Query  
Custom Wallpaper & Screen Saver

### Special Functions

GL Multiple Verification Modes  
GL Event Snapshot  
User Photo  
ZK Encrypted Card (Optional)

### Compatibility

Wiegand Slave Reader  
ZKBioSecurity  
Software

### Additional Info

Working Temperature: -10 °C ~ 50 °C  
Dimensions: 190.5 × 85 × 103 mm.  
ZKFace v7.0 Algorithm  
Face: FAR ≤ 0.001% FRR ≤ 1%  
Package Includes 12V 3A Power Supply

### Power

Operating Voltage 12V DC  
Current Draw < 500mA

## Configuration

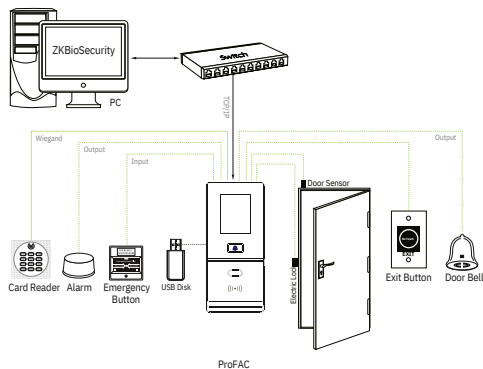

## Dimensions (mm)

